

Dome and Outdoor Fields Project

Scope of the Project

Scope

Build a 108,000 square foot dome with 3 outdoor lighted synthetic turf fields with an 6,000 square foot building attached to dome, walking trails and playground to be used by youth, adults and seniors.

Location

25.5 acre lot on Rt. 1A in Holden, ME (724 Main Road, Holden)

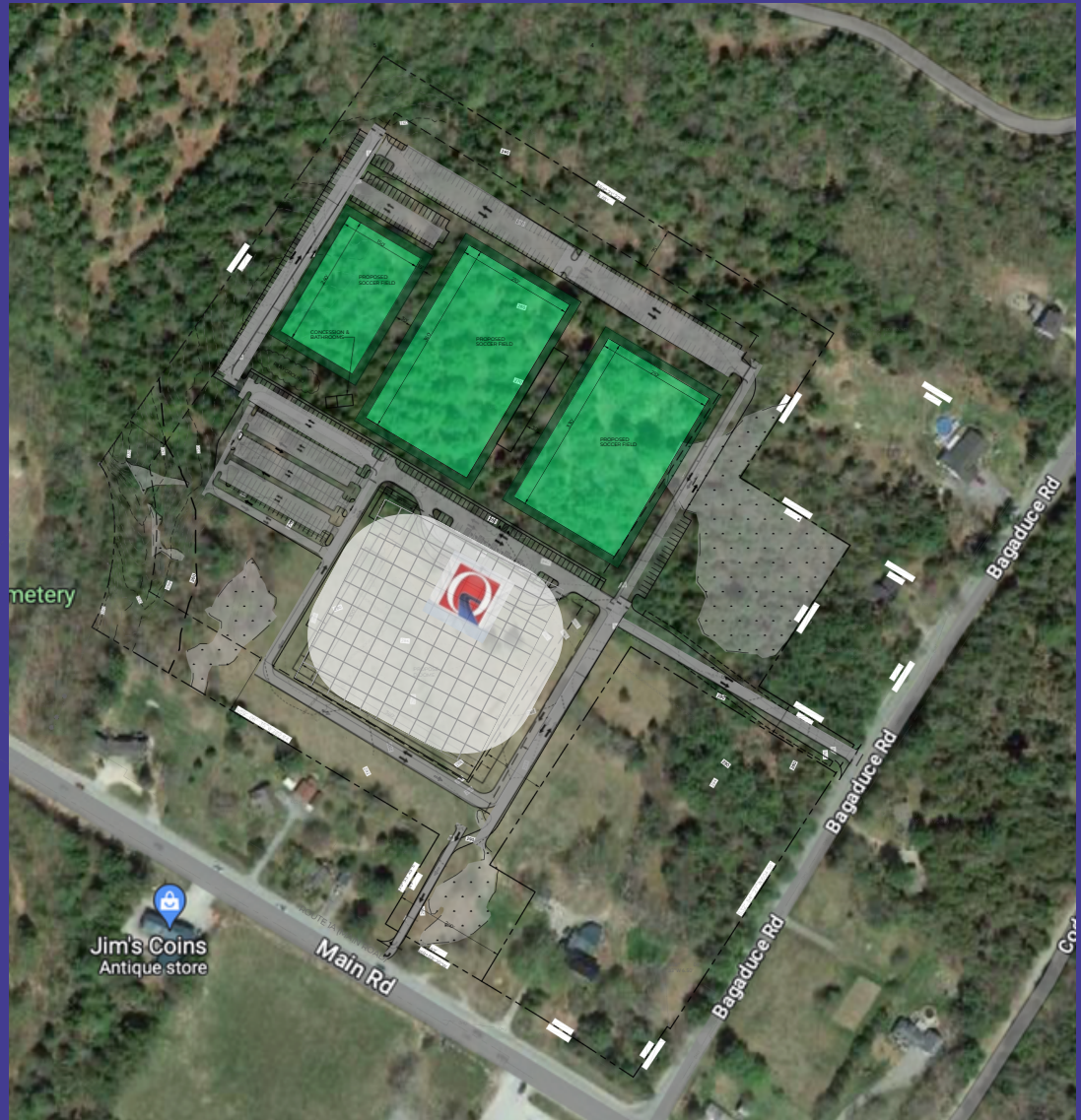

Why Support the Complex?

River City Athletics has outgrown its current facility. In order to provide the best possible educational and athletic opportunities for our youth, we need additional, improved space to accommodate our continued growth and the vital needs of the surrounding communities. The multi-sport complex will position Penobscot County with a showcase facility in Eastern Maine which will help grow economic development, tourism, and diversification efforts.

Maine has one of the highest childhood obesity rates in the country – this new complex will provide an opportunity for the almost 150,000 youth, adults and seniors within a 50 mile radius of Bangor to maintain and improve their physical well being on a year round basis.

(<https://censusreporter.org/profiles/31000US12620-bangor-me-metro-area/>)

Constructing this indoor/outdoor complex, will allow us to:

- Quadruple our year-round usable indoor space
- Significantly increase youth and adults participation in physical activity
- Provide a safe, high quality, drug-free and tobacco free facility
- Create an exciting opportunity to host regional and national competitions, high school play-offs, Olympic Development Program (ODP) events, tournaments, clinics, and multi-cultural events for a variety of sports and programs.
- Offer affordable outdoor field options for local organizations
- Increase residential and commercial property values and rental prices surrounding the site
- Attract new residents and businesses with a high-quality year-round athletic facility
- Generate revenue for local businesses
- Provide a showcase facility available to local schools, colleges, city recreation departments, and clubs (soccer, lacrosse, baseball, softball, field hockey, football), and to other community organizations to accommodate their specific needs.



Field Hockey Camps and Clinics









Eastern Maine Lacrosse Clinics



Adult Men's and Women's Leagues

Phase 1: Naming Right Opportunity

Dome & Building

	Option	Amount	Duration	Cost	Availability
✓	Sports Complex & Dome			\$ 150,000 per year	One
✓	Synthetic Turf Dome Field	ANONYMOUS	10 years	\$ 25,000 per year	One
	Main Dome Entrance	\$ 500,000	10 years	\$50,000 per year	One
★	Mezzanine	\$ 300,000	10 years	\$ 30,000 per year	Four
1 Left	Corner Logo Placement on Indoor Dome Turf	\$ 100,000	10 years	\$ 10,000 per year	   
✓	Dome Lobby		10 years	\$ 10,000 per year	One
	Party Room	\$ 75,000	5 years	\$ 15,000 per year	One
	Main Parking Lot	\$ 75,000	5 years	\$ 15,000 per year	One
	Goal Sponsor	\$ 50,000	5 years	\$ 10,000 per year	Eight
	Secondary Parking Lot	\$ 50,000	5 years	\$ 10,000 per year	One

Phase 1: Naming Right Opportunity







Dome & Building Continued

Option	Amount	Duration	Cost	Availability
Bathroom	\$ 50,000	5 years	\$10,000 per year	Two
✓ Batting Cage	\$ 25,000	5 years	 	

★ Companies can purchase multiple naming rights for the mezzanine.

Phase 2: Naming Right Opportunity

Outdoor Field Complex

Option	Amount	Duration	Cost	Availability
 Synthetic Turf Outdoor Field <div>  vs   </div>				
Main Building	\$ 700,000	10 years	\$ 70,000 per year	One
Corner Placement of Turf for Outdoor Fields	\$ 100,000	10 years	\$ 10,000 per year	Twelve
Stadium Seating	\$ 100,000	10 years	\$ 10,000 per year	One
Goal Sponsor	\$ 50,000	5 years	\$ 10,000 per year	Six
Playground	\$ 50,000	5 years	\$ 10,000 per year	One
 Concessions <div>  </div>			\$ 10,000 per year	One
Walking Path	\$ 25,000	5 years	\$ 5,000 per year	One

Current Naming Rights

Dome & Building
+
Outdoor Field Complex

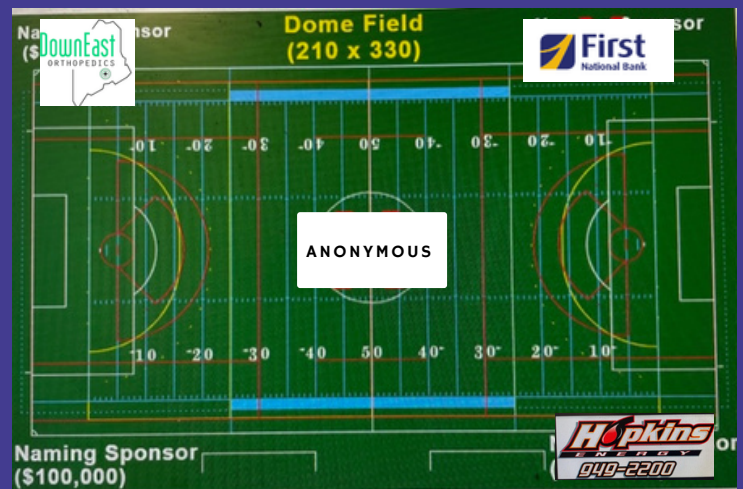
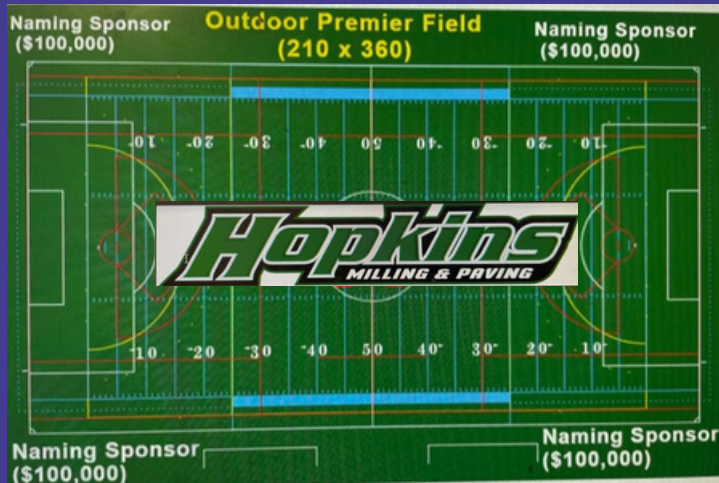

Current Naming Rights

Dome & Building:

Mezzanine



Main Viewing Deck Entrance

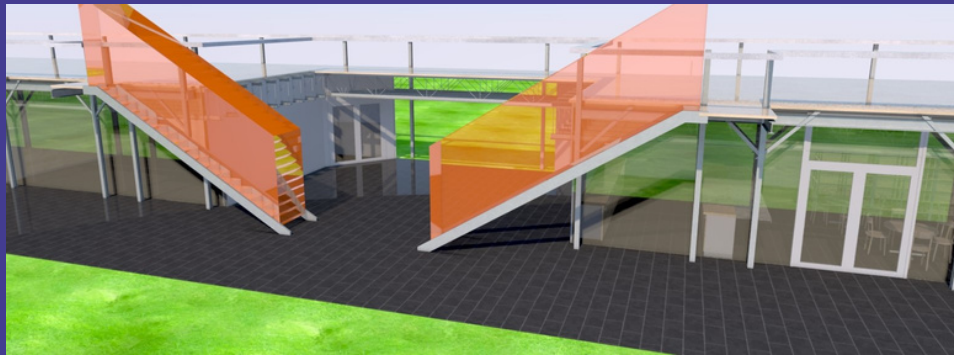

Leased Spaces Below Viewing Deck



Leased Spaces



Advertising Partnership Packages

Option	Amount	Duration	Cost	Availability
Level 1	\$ 24,000	3 years	\$ 8,000 per year	Ten
Level 2	\$ 15,000	3 years	\$ 5,000 per year	Six
Level 3	\$ 7,500	3 years	\$ 2,500 per year	Nine
Level 4	\$ 6,000	3 years	\$ 2,000 per year	Ten
Level 5	\$ 3,000	3 years	\$ 1,000 per year	Ten

6 Remaining

9 Remaining



Advertising Partnership Benefits

Level 1	Level 2	Level 3	Level 4	Level 5
<p>Sponsor name / logo displayed on 5 x 15 banner on dome wall</p> <p>Sponsor name / logo displayed on 6 x 12 banner at outdoor synthetic turf fields</p> <p>Sponsor name on schedules and other literature, including the Quirk SportsPlex website</p>	<p>Sponsor name / logo displayed on 5 x 15 banner on dome wall OR on a 6 x 12 banner at outdoor synthetic turf fields</p> <p>Sponsor name on schedules and other literature, including the Quirk SportsPlex website</p>	<p>Sponsor name / logo displayed on a 4 x 8 banner at outdoor synthetic turf fields</p> <p>Sponsor name on schedules and other literature, including the Quirk SportsPlex website</p>	<p>Sponsor name / logo displayed on a 4 x 8 banner at one of the outdoor synthetic turf fields or inside the dome</p> <p>Sponsor name on schedules and other literature, including the Quirk SportsPlex website</p>	<p>Sponsor name / logo displayed on a 2 x 4 banner at one of the outdoor synthetic turf fields or inside the dome</p> <p>Sponsor name on schedules and other literature, including the Quirk SportsPlex website</p>

Participating Organizations

- Bangor High School Varsity boys and girls soccer teams
- Bangor Little League and Legion Baseball Winter Training Program
- Bangor Region Leadership Institute (Laugh-In Fundraiser)
- Bangor Soccer Club (over 600 players)
- Beal College Police Academy program
- Birthday Parties (typically over 50 per year)
- Blackbear Elite Field Hockey Clinics and Camps
- Brewer High School Varsity boys and girls soccer teams
- Brewer Soccer Club (over 250 players)
- Community Fundraisers (local organizations use facility to raise money for great causes)
- Coldbrook Travel Soccer Club (over 200 players)
- Corporate Challenge Series - Local businesses enter teams and compete in soccer, cornhole, ping pong, dodge ball, whiffle ball, kickball, bubble ball soccer, walking and running activities, and much, much more
- Dances – hold Father / Daughter and Mother/Son dances four times per year (over 200 participants) Disc Golf Putting League
- Eastern Maine Lacrosse (over 200 participants)
- First Touch Academy (individual and small group sports and strength trainings)
- FusionBangor Dodgeball League (over 250 adults per year) Glenburn Little League
- Hampden Academy boys and girl's soccer teams
- Hampden Academy field hockey team
- Hermon High School Baseball team
- Hermon High School boys and girl's soccer teams
- Hermon Regional Softball (HRS)
- Hermon Baseball with Coach Todd Applebee
- Hitting Clinics with Matt Stairs, retired MLB professional player
- Home School Club – Dodgeball and other sports during winter months Husson University men's and women's lacrosse, softball, and soccer programs Husson University men's football program
- John Bapst Football Team
- John Bapst boys and girls varsity soccer teams
- Maine Adrenaline AAU Softball Team
- Maine Frost AAU Softball
- Maine Junior Blackbears Ice Hockey (dry land training)
- Maine Sting Baseball
- New England Revolution Academy for Soccer Camps and Clinics
- Orrington Little League
- Parkside Children's Learning Center

Participating Organizations

- Penobscot Christian School sports programs
- Performance Soccer Schools (200+ participants ages 2-12)
- Queen City Goalkeeper School (goalkeeper-specific training)
- River City youth soccer organization (18 teams ages 10-18 - 375+ participants) SoccerMaine Coaching Education (Grassroots Youth licenses, and D license courses) SoccerMaine Referee Certification and Recertification courses
- Softball Pitching classes with Tim Crowell and Rick Roberts
- Stillwater Academy TOPSoccer Program for children with physical and mental disabilities Twin City Football (semi-professional)
- Women's Field Hockey League (30-50 per session)
- Youth and Adult Soccer Leagues - 400 youth and 650 adults play in our youth and adult soccer leagues every 8 weeks Coed, Women's Open, Women's Over 30, Men's Over 30, Men's Open, High School, Middle School, Grades 1 & 2, and Grades 3-5 leagues Programs

Who Advertises With Us?

ABM Mechanical, Apex Metals, Appalachian Lawn Care, Bangor Braces, Bangor Savings Bank, Brewer Veterinary Clinic, Butler Excavation, Camden National Bank, Danforth's, DC Wellness Center, DDS Rank, Diversified Ink, Downeast Orthopedics, First National Bank, Haley Ward, Hammond Lumber Company, Haverlock, Estey and Curran, Hermon Meadow Golf Course, Invironments, LA Training, LM Strategy, Nate Holyoke Builders, Nicklbeth Turf Solutions, Newport Chiropractic, Parkside Learning Center, Penobscot Medical Aesthetics, Predator Pee.com, Realty of Maine, Therapy Partners Twin City Metal, Twin City Tire, and UPS.



River City Giving Back to Community

Mission and Vision

MISSION

River City Athletics is a volunteer based non-profit organization established to meet the needs of the youth sports community of Eastern, Central and Northern Maine, with a primary focus to provide safe and adequate indoor and outdoor playing facilities for the Eastern Maine region.

VISION

Offer safe and reliable indoor and outdoor fields for community members and organizations to remain active 12 months of the year. River City Athletics will provide and administer an organized structure with safe and adequate indoor and outdoor playing fields for all sports. A primary focus for each facility and program is promoting a healthy lifestyle through education, environment (drug-free and tobacco-free), and safety.

For More Information Contact:

 [HTTP://WWW.RIVERCITYMAINE.COM/](http://www.rivercitymaine.com/)

 RIVERCITYMAINE@GMAIL.COM

 (207) 991-8940

To Donate:



VENMO: F4K-RCA



129 FARM ROAD, BANGOR, ME 04401



ONLINE PLEDGE- SCAN BELOW:



Follow our progress:

Instagram: @quirk_sportsplex

Facebook: @www.facebook.com/rivercitymaine

Thank you

MJ Ball - Executive Director at (207)-991-8940

